

BI-METAL LINKS BKR

1. Tick a box to identify the standard blank which is closest to your required design.
2. Complete the Conductor Details section inserting your requirements. Please note all details are mandatory.
3. Enter your required dimensions staying within the guidelines in the standards table.
4. Complete customer contact and authorisation details. Please note all details are mandatory.
5. Fax to Utilux Custom Connectors.

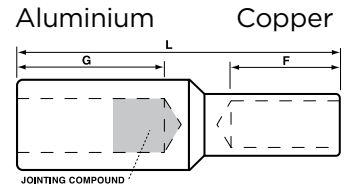
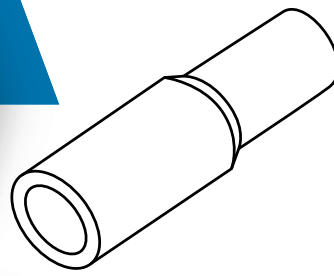

1. STANDARDS & GUIDELINES

All dimensions in mm

Catalogue No.	Conductor Range mm ²	Copper - F Recommended	Aluminium - G Lengths	L Max
<input type="checkbox"/> BKX10-35/1	10-35	21.5	32	70
<input type="checkbox"/> BKX50-70/1	50-70	21.5	32	70
<input type="checkbox"/> BKX95-120/1	95-120	40	60	120
<input type="checkbox"/> BKX150-185/1	150-185	40	60	120
<input type="checkbox"/> BKX240-300/1	240-300	40	60	120
<input type="checkbox"/> BKX400-630/1	400-630	60	70	160

2. CONDUCTOR DETAILS

LARGE END: MATERIAL - Al <input type="checkbox"/> Metric <input type="checkbox"/> Imperial Area: mm ² /in ² _____ <input type="checkbox"/> Flexible <input type="checkbox"/> Compacted Stranding: _____ <input type="checkbox"/> Other		SMALL END: MATERIAL - Cu <input type="checkbox"/> Metric <input type="checkbox"/> Imperial Area: mm ² /in ² _____ <input type="checkbox"/> Flexible <input type="checkbox"/> Compacted Stranding: _____ <input type="checkbox"/> Other	
---	--	---	--

Comments: _____

3. REQUIRED SPECIFICATIONS

Dimensions: (IF NON-STANDARD)

F: _____ mm

G: _____ mm

Qty: _____

4. CUSTOMER DETAILS

Company: _____

Requested by: _____

Tel: _____

Purchase Order No: _____

TE INTERNAL SALES USE ONLY

Part No: BKR

Sales Order No: _____

Drawing No: _____

Entered by: _____

5. FAX THIS FORM TO UTILUX CUSTOM CONNECTORS - (02) 9502 2062

ORDERS FAXED TO UTILUX CUSTOM CONNECTORS BY 3PM WILL BE DESPATCHED BY 3PM WITHIN 2 BUSINESS DAYS OF FAX STAMP DATE

SPECIALY MANUFACTURED PRODUCTS CANNOT BE RETURNED FOR CREDIT.